



CE

PCBL 1600/1800 POWER WHEELCHAIR MODERN INSTRUCTIONS FOR USE

Edition 01.2022

TABLE OF CONTENTS

1. Practice before operating.....	3
2. User's safety (indications and contraindications).....	3
3. Driving outdoor.....	4
4. Driving over the hills on uneven terrain.....	4
5. Technical parameters.....	5
6. Battery and charging.....	12
7. Maintenance and cleaning.....	13
8. Specification.....	15

Please, read the instruction carefully before the first use of the wheelchair. If any part of the text is not clear or if you need any further information, please, contact your dealer.

The PCBL wheelchair is designed according to the latest trends and technology. Its construction enables optimal adaptation to user's needs. Solid and durable construction, innovative solutions and reliable safety systems guarantee maximum comfort of use.

In order to ensure smooth wheelchair operation and safety the wheelchair should be regularly checked at a service point. In case of any doubts or needs, please, do not hesitate to contact your local dealer or service point.

Please, make sure that you filled in the guarantee form and that you returned it to your dealer. It will help to ensure the best service.

Not following the instruction may result in vehicle damage or serious injury.

1. PRACTICE BEFORE OPERATING

- Before driving the vehicle on everyday basis, you should find an open area such as a park to practice maneuvers .
- We recommend that when you practice driving you should be accompanied by an assistant.
- Always make sure that the vehicle is set off before getting in or getting out of the vehicle. Always check that the speed setting is chosen according to your experience and skills.
- While practicing, keep the speed at the slowest position.

In order to drive safely, make sure that you are familiar with vehicle characteristics and ways of driving.



First, practice moving forward.

Make sure that the speed is set on the slowest position.



Then, practice "S" turns.



Finally, practice driving backwards.

Please, mark that while driving backwards the vehicle always moves slower regardless of the speed setting.

2. USER'S SAFETY

- Do not carry passengers
- Do not drive after drinking alcohol
- Consult your physician to check if your medications impair your driving abilities
- Do not use any personal communication devices such as CB radios, cellular phones
- Do not tow a trailer
- Do not drive across a slope

Indications: A powered wheelchair electric is a quality of life device designed to ensure mobility.

Contraindications: Contraindications for sitting position.

3. DRIVING OUTDOOR

- The wheelchair is not designed to move in the street traffic
- Do not use the wheelchair during rain or snow, when the temperature is higher than 30° or lower than 0°
- Do not use the wheelchair on soft, uneven, unprotected surfaces such as grass, gravel, sand or decks, beside a river, lake
- Do not use the wheelchairs for off-road driving
- If possible, do not use the wheelchair outdoors at night
- Make sure that there are no obstacles behind you when you drive backwards. We also recommend setting the speed at the slowest position
- Do not stop suddenly, always try to make turns gently
- Always keep your arms on the armrests and feet on the footrest while driving
- Do not try to climb curbs higher than 7cm
- Do not try to drive over a hole/gap wider than 10 cm

4. DRIVING OVER THE HILLS AND ON UNEVEN TERRAIN

Driving on the hills and other uneven terrains is more dangerous than driving on flat surfaces. Following the below rules is essential to avoid accidents and serious injuries.

- Do not try to climb a hill which grade exceeds 10°
- Do not move backwards while going up/down the hill
- Do not use the wheelchair on soft, uneven, unprotected surfaces such as grass, gravel or sand
- When you drive down the slope, choose the slowest speed
- Do not get in or off the wheelchair if it stays on a slope (in order to get in/off the wheelchair you need to place it on flat surface)
- Always climb or descend the hills perpendicular to the slope.

5. TECHNICAL PARAMETERS



1. controller
2. armrests
3. backrest
4. seat
5. footrests
6. anti-tip wheels
7. rear wheels
8. front wheels
9. motor
10. front light

Assembly

1. Install the battery by putting it into the rails placed on the wheelchair frame under the seat.
2. Assemble the armrests – choose the desired height and screw in the butterfly screw.
3. Assemble the swing away footrest, block them in a chosen position.
4. Install the control panel: put the control panel onto its holder, choose its optimal position and screw in the butterfly screw.
5. Connect the main supply to the control panel.
6. Using the Velcro bands, attach the cushion to the seat.



Reclining backrest and seat

It is possible to have four different seat positions.

Unblock the blocking screw placed on the frame, under the seat. Choose required position and screw in the screw making sure it is blocked.

Assembling and removing the footrests

Pull the blocking lever. In order to remove the footrest, pull it outside and remove. In order to assemble the footrest, push it inside till the blocking mechanism is blocked.

Adjusting the control panel position

Unscrew the butterfly screw, adjust the control panel and screw in the butterfly screw.

Moving the control panel to left/right armrest

Disconnect the supply from the control panel. Remove both armrests. Unscrew and remove the control panel holder. Attach the holder to left/right armrest and then install the control panel on the holder. Install the armrests and screw in their blocking screws.

Adjusting the armrest and seat width

In order to adjust armrest height, locate the screw on the holder placed horizontally on the side of the seat. Unscrew the screw, put the armrest into the holder and choose desired height. Then, screw in the screw.

You can adjust the seat width by increasing the distance between the armrests. Unscrew the blocking screw placed under the seat, move the armrests outside and block the screw.

Adjusting the backrest

In order to adjust the backrest angle, pull the Velcro bands backwards (you can find the Velcro bands at the bottom part of the backrest) and choose required backrest position. If you loosen the Velcro band, the backrest will block automatically.

Motor clutch

The power chair is equipped with two clutch levers. The levers allow you to disengage the drive motors and maneuver the chair manually.



WARNING! Please, remember that when the system of electric drive is turn off, the electromagnetic brakes are also disconnected. Never switch off the electromagnetic drive if there is no person who may push your wheelchair. Never switch off the electromagnetic drive if the wheelchair is staying on the slope or on any other inclined terrain – the wheelchair may go downhill which may lead to wheelchair damage or injury.

1.The red lever is up, the electric drive is turn off. The wheelchair can be pushed.

2.The red lever is down, the electric drive in on.



Electronic control panel

Electronic control panel allows to control power wheelchair, battery power status and general condition of the whole electronic system.

Electronic control panel is usually placed on the armrest and joint to the battery and motor. The panel can be attached to the left /right armrest or behind the wheelchair (when it is used by a caregiver).

Joystick

The joystick allows to control direction and speed of movement. Push the joystick forward to release the electromagnetic brake and set the wheelchair in motion. The more you push the joystick forward, the faster the wheelchair will move. If you release the joystick, the wheelchair will slow down and stop. If you move the joystick backwards, you will drive in reverse.



WARNING! If the wheelchair starts to move in an unexpected direction, release the joystick and let it return to central, neutral position. If the joystick is not damaged, the brakes will be activated and the wheelchair will stop.

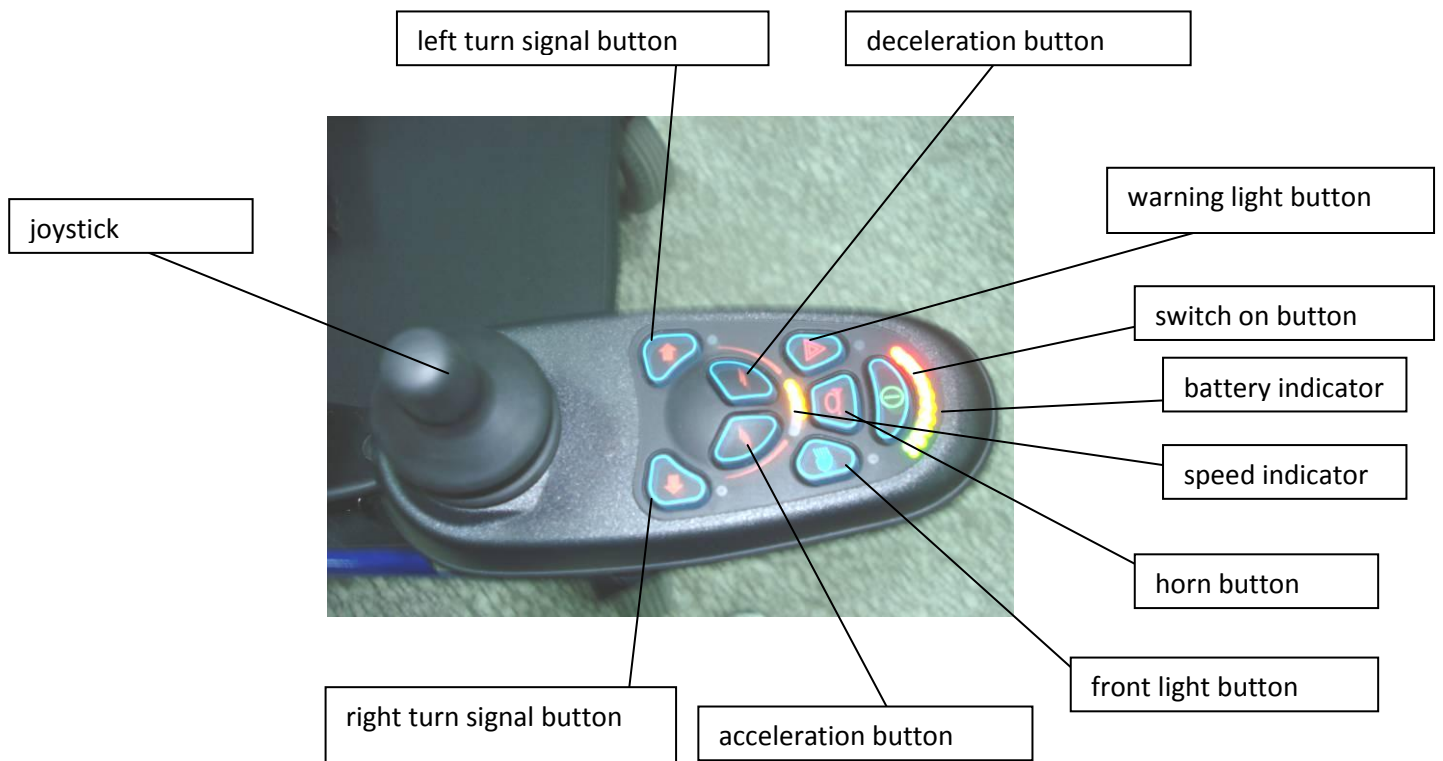

Switch on button

NEVER, even in case of danger or other unpredictable situations, turn off the wheelchair by pressing the switch on button – the wheelchair will abruptly stop which may cause falling down. Always turn off the power if you do not intend to drive it – in this way you will avoid unpredictable wheelchair 's movements.

Battery status bar

You can find the battery status bar at the top of controller. Using the color light indicator, the battery status bar provides information on supply, approximate power of the batteries, electric systems of the wheelchair using a color code.

Constant red, yellow and green light indicate that batteries are fully charged, electric systems and electronic system of control panel are efficient.

Constant red and yellow light indicate that you should charge batteries, the electric systems and electronic system of control panel are efficient.

Only constant red light or slowly blinking red light – you should charge the batteries as soon as possible, the electric systems and electronic system of control panel are efficient.

If the lights blink, the electronic system or electric system does not work properly.

If the warning lights blink continuously, the joystick was not is neutral position when the power wheelchair was switched off. Turn off the power, release the joystick and again turn on the power.



WARNING! If you followed the user's manual instructions but the warning lights are still blinking, please, contact your dealer.

Speed adjustment buttons

There are two speed adjustment buttons – if you want to slow down, press deceleration button. The actual speed is shown on the indicator placed below the battery status bar. The faster you move, the more lights are on.

Horn button

Press the button to activate the horn.

Charger socket

The socket is used for battery charging – plug to the power outlet (max 12A).

Driving lights button

When you switch on the driving lights, the corresponding light icon will activate.

Left turn button

When you press the button, the corresponding light icon will activate. In order to switch off the winker, press the button again.

Right turn button

When you press the button, the corresponding light icon will activate. In order to switch off the winker, press the button again.

Warning light button

Activates the warning lights.



WARNING! If any of the control light indicators flashes or many different light icons will light, one of the control panel button may be damaged.

Connectors



WARNING! Always make sure that the electronic control panel is properly connected to the other parts) motor, battery. Not following this rule may lead to control panel damage or damage to other wheelchair parts.

Motor connector - connects the electronic control panel and motor

Battery connector - connects the electronic control panel and battery

Driving lights connector - connects the electronic control panel and lights connector

Overload protector

The batteries are equipped with overload protector (50AH) which automatically disconnects a load when current exceeds a predetermined value.

When the wheelchair is overloaded, the motor power is being reduced and the wheelchair speed diminished till the motor and electronic control panel reach admissible temperature. If necessary, the overload protector will disconnect the load and the wheelchair will stop and wait till the motor is cooled down.

Battery

The wheelchair is equipped with two 12 V maintenance-free batteries.

In order to obtain maximum efficiency of your battery please, follow the instructions below:

1. Charge each battery before the first use. The batteries will reach 90 % of their capacity.
2. Use the power chair moving slowly not far away from the place where you can charge the batteries again until the batteries discharge completely. Then charge them again for 9-10 hours.
3. After four or five such charging cycles the batteries should top off at 100% charge capacity and last for long time.

WARNING



Never let the batteries unload completely. If you notice last yellow or first red light indicator on the controller- charge the batteries. Remember that the charging cycle should take about 9-10 hours, till the batteries are fully charged.

Never stop or suspend the charging if batteries are not fully charged. Not following the above rules may lead to battery damage.

If you store the batteries, make sure they are fully charged.

If you do not use your wheelchair on regular basis, you should charge the batteries at least every two weeks. Remember that each charging must be completed and last about 9-10 hours, till the batteries are fully charged.

If you notice any leakage from the battery, please, contact your distributor.

When charging the batteries, always keep the wheelchair and charger away from any heat source.

6. BATTERY & CHARGING

The charger is the key part of the wheelchair. In order to charge the batteries quickly and safely ,use only the original charger supplied with the wheelchair and follow the below rules.

1. Always plug the charger into the charging socket placed at the bottom part of the controller. Then, plug it to the power outlet.
2. Follow the instruction outlined on the charger board.
3. The time of charging depend on battery condition. The best option is to load batteries at night-when batteries are loaded, the charger will stop working automatically.
4. When loading is completed, remove the charger from power outlet and then from the charging socket. Never leave the charger connected to the charger socket if it is not connected with power outlet.

If you need to replace the batteries, please, contact your distributor.



WARNING! Never plug the charger into the power outlet of more than 12 V. Always use the original charger supplied with the wheelchair. Not following the above rules may lead to charger overheating and fire. Do not charge the batteries in humid places, conditions. Never stop or suspend charging if the batteries are not completely charged. The charging should last till the time the batteries are fully charged.

Changing the tyres

1. Unscrew the wheel blocking screw.
2. Remove the wheels, remove the tyre and change it with a new one.
3. Install the wheel and screw in the blocking screw.

7. MAINTENANCE AND CLEANING

In order to ensure that your wheelchair will give you years of trouble-free operation, the user should regularly inspect and maintain the wheelchair and deliver it to the authorized distributor for annual comprehensive maintenance and inspection. If you find any problems or abnormalities while using the wheelchair, please, contact the nearest authorized service point.

Annual inspection

Annual inspection is to check if the wheelchair is in good shape and if all the systems (driving system, electric and electronic systems) work properly. It also helps to prevent possible problems which may arise from existing defects. The inspection should include:

1. Tire inspection
2. Inspection of the battery and the wiring
3. Inspection of the controller control program and checking if it requires re-editing.
4. Inspection of the main frame
5. Inspection of backrest and seat cushions

Maintenance and cleaning – general rules

1. Protect the controller and joystick against violent shakes and hitting.
2. Avoid long exposure of the power wheelchair to extreme cold, hot or humidity.
3. Always keep the controller and joystick clean.
4. Keep the wheelchair away from direct contact with water.
5. Always keep the frame and upholstery clean. Use soft, dry cloth to clean the main frame and the upholstery. Do not use any abrasive. While cleaning, do not use any detergents directly on the controller, battery charger or other power connectors.
6. Lightly oil axle pin, wheel axle and bearings every three months.
7. Use only the original batteries supplied with wheelchair. If you want to replace the batteries, contact your distributor.
8. Regularly charge the batteries. Always make sure that the charger is properly connected to the power output. Never disconnect the charger by pulling the cord.
9. Regularly inspect the joystick condition – switch off the power and check if the joystick is not damaged. Try to push the joystick and then release it - it should automatically go back to its neutral,

central position. Check the rubber boot around the base of the joystick for damage. Visually inspect the boot. Do not handle or try to repair it. See authorized dealer if there is any problem.

10. Carefully check all the wires – if you notice any damage contact the authorized service point.

Make sure that all wiring connections are correct and proper; do not over-tighten the screws.

11. Ensure that all parts of the controller system are securely fastened to your power chair.

12. Your power wheelchair should be stored in a dry place free from temperature extremes. When storing, disconnect the batteries from the power chair, see "Batteries and charging" in this manual. If you fail to store the unit under the above conditions, the frame can rust, and the electronics can be damaged.

Problem checklist

1. Problem: The controller lights blink quickly when the power is switched on.
Action: Switch off the power, put the joystick in its neutral position. Then wait few seconds and reactivate the wheelchair
2. Problem: The controller lights flash slowly while driving.
Action: The slow flashing means that the battery charger level is low and the batteries should be charged as soon as possible.
3. Problem: The controller lights flash continuously and it is not possible to control the wheelchair.
Action: The continuous flashing of the lights indicates there may be an electrical problem. Switch off the power and contact your authorized service point.
4. Problem: The red controller light placed on the battery charger does not light during charging.
Action: Check that all the wires have been properly connected and plugged into a power outlet. If the red controller still does not light, disconnect the battery charger from the power outlet and control panel, switch off the wheelchair and contact authorized service point.
5. Problem: The chair is difficult to steer.
Action: First, check if four wheels are properly installed on the power wheelchair. Second, check to see if the clutch lever is engaged correctly.

NOTE: If you detect that there are problems with the motors, the battery charger, the controller or damage to the power chair frame, it is recommended that you contact the nearest authorized service point.

Storage

The power wheelchair should be stored in a dry place, free from temperature extremes. Always remove the batteries when the wheelchair is stored. Remember that like most electrical equipment, your power wheelchair is susceptible to damage. Avoid damp environment of any kind. If you store the wheelchair in inappropriate places, the frame may easily become rusted and the electronic components may be damaged.

The power wheelchair PCBL1600-1800 may be safely used for 5 years from the production date if operated and used according to its purpose and rules outlined in this user's manual.

8. SPECIFICATION

Model no	PCBL 1600 1800	
Seat width	40,7 cm	45,7 cm
Length	115 cm	
Width	59,5 cm	64,5 cm
Caster wheel	9"	
Drive wheel	14"	
Weight capacity	136 kg	
Max speed	12 km/h	
Range	36 km	
Turning radius	96 cm	
Battery	12 V	
Anti-tip	Two rear, anti-tip wheels	
Weight)battery included	83 kg	85kg



DISPOSAL OF WASTE ELECTRICAL AND ELECTRONIC EQUIPMENT

This symbol on the products or accompanying documents means that used electrical or electronic products should not be disposed of with the normal household waste. For proper disposal, refurbishment or recycling, please take these products to the collection points for this type of waste. Alternatively, in some EU countries or other European countries, you may return your product to your local retailer when purchasing a similar new product. By disposing of this product correctly, you will help to conserve valuable natural resources and support the prevention of potential negative effects on the environment and human health, which could result from incorrect disposal. For further information, please contact your local municipality or collection point waste collection points. Penalties may be imposed in accordance with local regulations if this product is disposed of in an inappropriate manner. For parties within the European Union, If you wish to discard electrical or electronic equipment, please obtain the necessary information from your retailer or supplier. Elimination in countries outside the European Union. This symbol is valid in the European Union. If you wish to decommission this appliance, please obtain the correct decommissioning information from your local authorities or from your retailer.



Medical device

Contact details



mdh Sp. z o.o.

ul. Maratońska 104, 94-007, Łódź, Polska

tel. +48 42 674 83 84

fax. +48 42 636 52 21

www.mdh.pl www.viteacare.com